

heraklion's new

students **tralo a., voradaki g.** supervisor **ougrinis k.**

airport: a crossroad of civilizations.

Contemporary international airports are the definition of the term “**non-places**”. Their structure serves the two and only purposes of transferring and consumerism. There is no room either for the past or the future; only the present exists, abolishing every single trace of reference and history. Supermodernity is reflected precisely on the design and the function of an airport, where individuality prevails along with the lack of personal identity. Passengers must confirm their identities tactically in specific time and space during their staying at an airport, but between the confirmations they are totally released by them. During these periods of time from one confirmation to the next, the individual acquires a shared identity that is common for all the passengers. Personality is negated and the personal experience and history are passed over until the final exit from the terminal. This relative anonymity provides the individual with a sense of freedom and a condition of solitude and similarity at the same time.

An airport is a place where people from all around the world, with different cultures, traditions, notions, memories and experiences meet. However, they hardly ever interact with each other. Passengers come and go and no kind of communication takes place among them, resulting in losing the chance of getting knowledge from other passengers' experience, with completely different background. In other words, the accumulation of so many people is equivalent to the accumulation of abundant knowledge, which is not utilized in the case of the airport.

The exchange of information, even in the simplest way (e.g. chatting), could be considered a valuable contribution to the broadening of an individual's mental horizon. This can be easily achieved in a place such as the airport, where there are so many different people, each one of them carrying his own history. Any personal history includes and carries pure knowledge, which is as unique as the human fingerprint.

AIRPORT: A NON-PLACE

AIRPORT IN NUMBERS

ephemeral
globalization
transient
free market
advertisement
technological networks of communication
and information
temporary abodes
solitary contractuality
words
landscape - text
shared identity
anonymity / liberation
fleeting
shopping = movement
solitude
similitude
present moment
overabundance of events
spatial overabundance
individualization of refer-
ences
supermodernity
circulation
consumption

* The place / non-place pairing is an instrument for measuring
the degree of sociality and symbolization of a given space.

ATL	89,331,622	USA	15,079
PEK	73,948,113	BRAZIL	4,072
ORD	66,774,738	MEXICO	1,819
LHR	65,884,143	CANADA	1,404
HND	64,211,074	RUSSIA	1,293
LAX	59,070,127	ARGENTINA	1,141
CDG	58,167,062	COLUMBIA	990
DFW	56,906,610	BOLIVIA	881
FRA	53,009,221	PARAGUAY	800
DEN	52,209,377	INDONESIA	684
HKG	50,348,960	SOUTH AFRICA	578
MAD	49,844,596	PAPUA NEW GUINEA	562
DXB	47,180,628	GERMANY	549
JFK	46,514,154	UNITED KINGDOM	505
AMS	52,211,749	CHINA	502
CGK	44,355,398	FRANCE	475
BKK	42,784,961	AUSTRALIA	465
SIN	42,038,777	ECUADOR	428
CAN	40,975,673	UKRAINE	425
PVG	40,578,621	VENEZUELA	409
IAH	40,479,569	GUATEMALA	372
LAS	39,757,359	CHILE	366
SFO	39,253,99	INDIA	352
PHX	38,554,215	IRAN	319
CLX	38,254,207	PHILIPPINES	254
FCO	36,227,778	SWEDEN	249
SYD	35,991,917	SAUDI ARABIA	217
MIA	35,698,025	ZIMBABWE	216
MCO	34,87,899	PERU	211
MUC	34,721,605	BULGARIA	210

WORLD: 43,982

Airport = Mall



QUESTIONARY

What is the average time spent at the airport before entering the airplane?

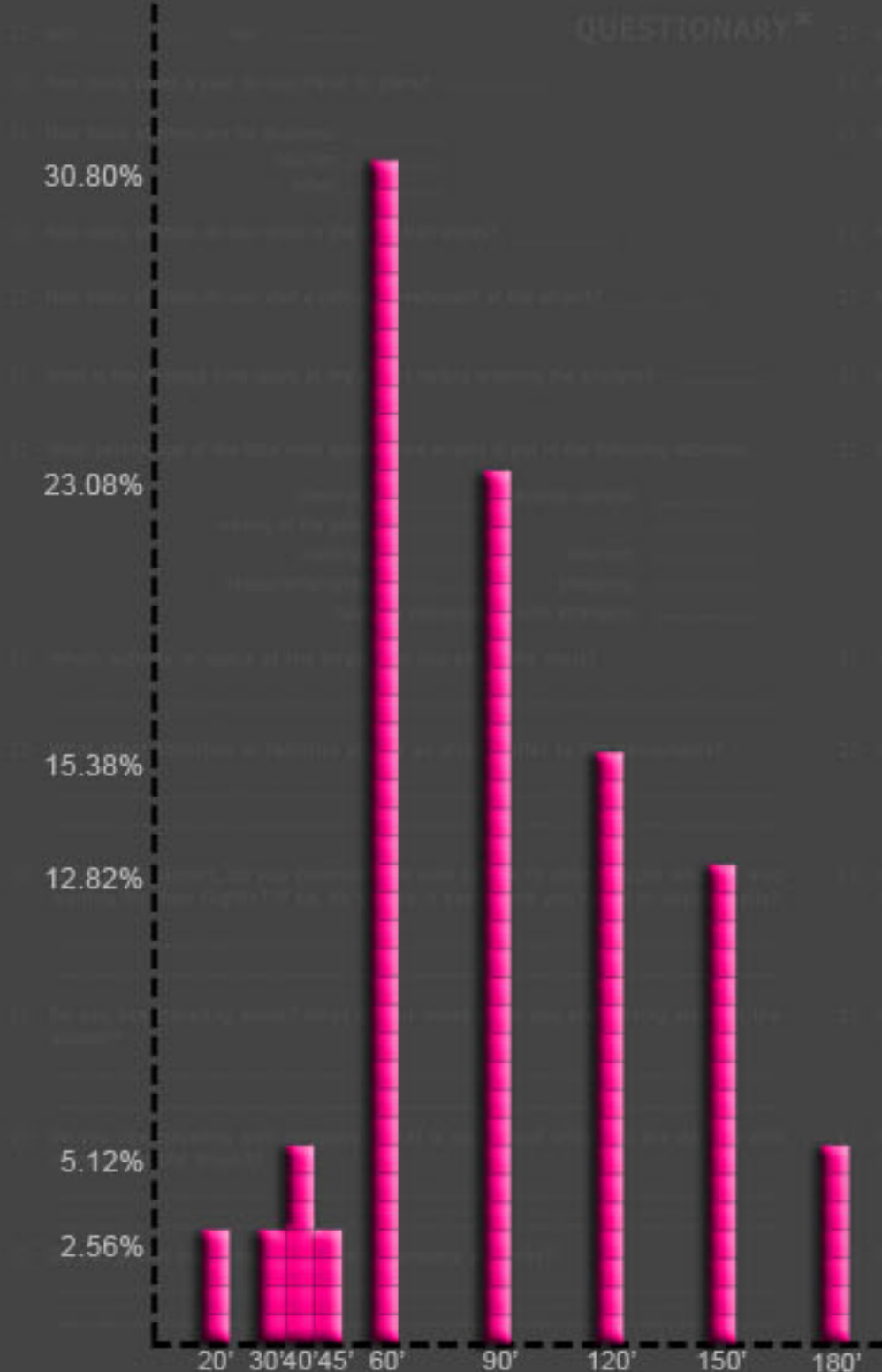

How much time do you spent on the following activities?

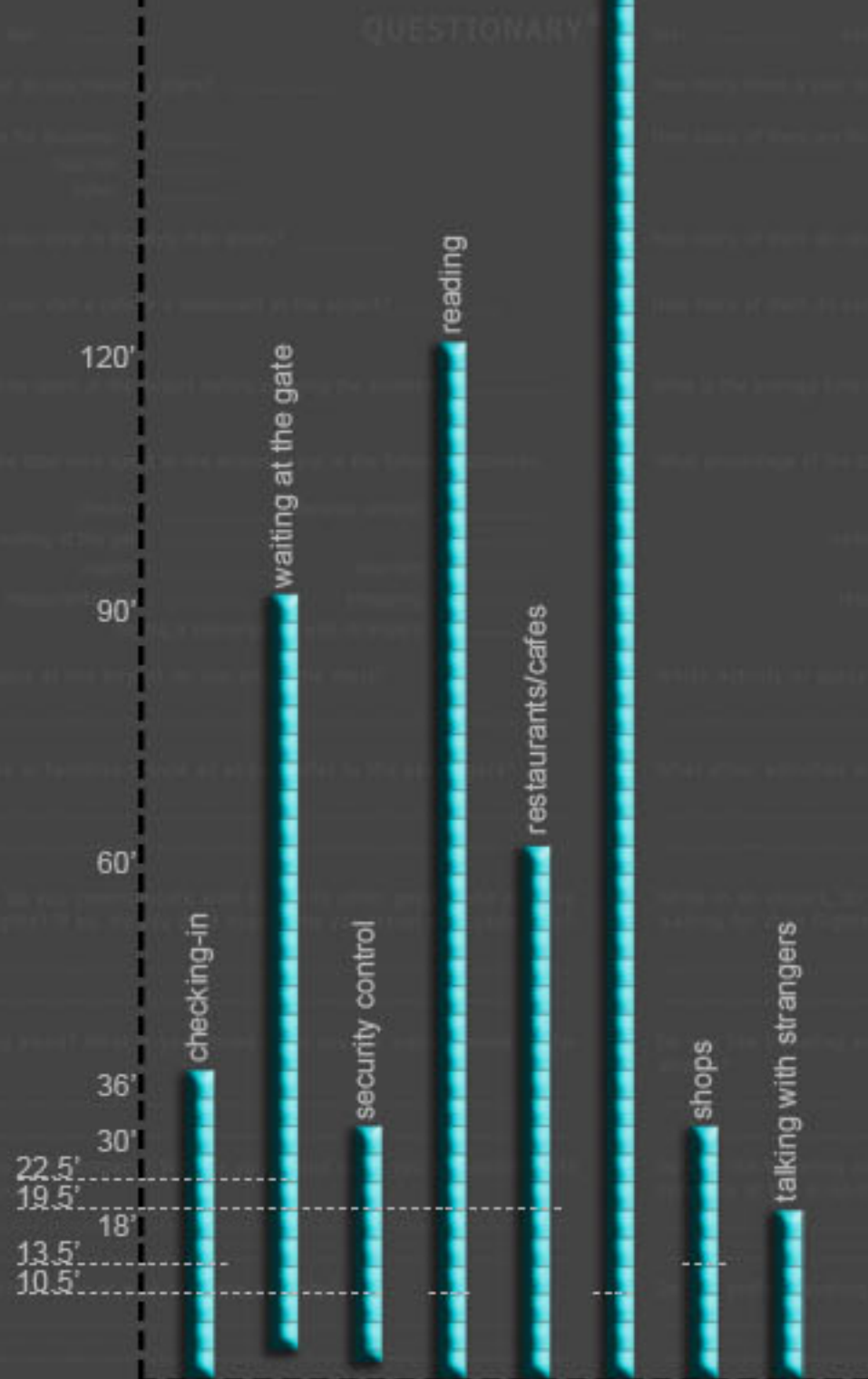

What is your mood while you are waiting alone at the airport and what is your mood while you are waiting with company?
Do you prefer traveling alone or with company and why?

QUESTIONARY*

QUESTIONARY*

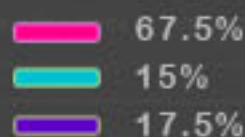
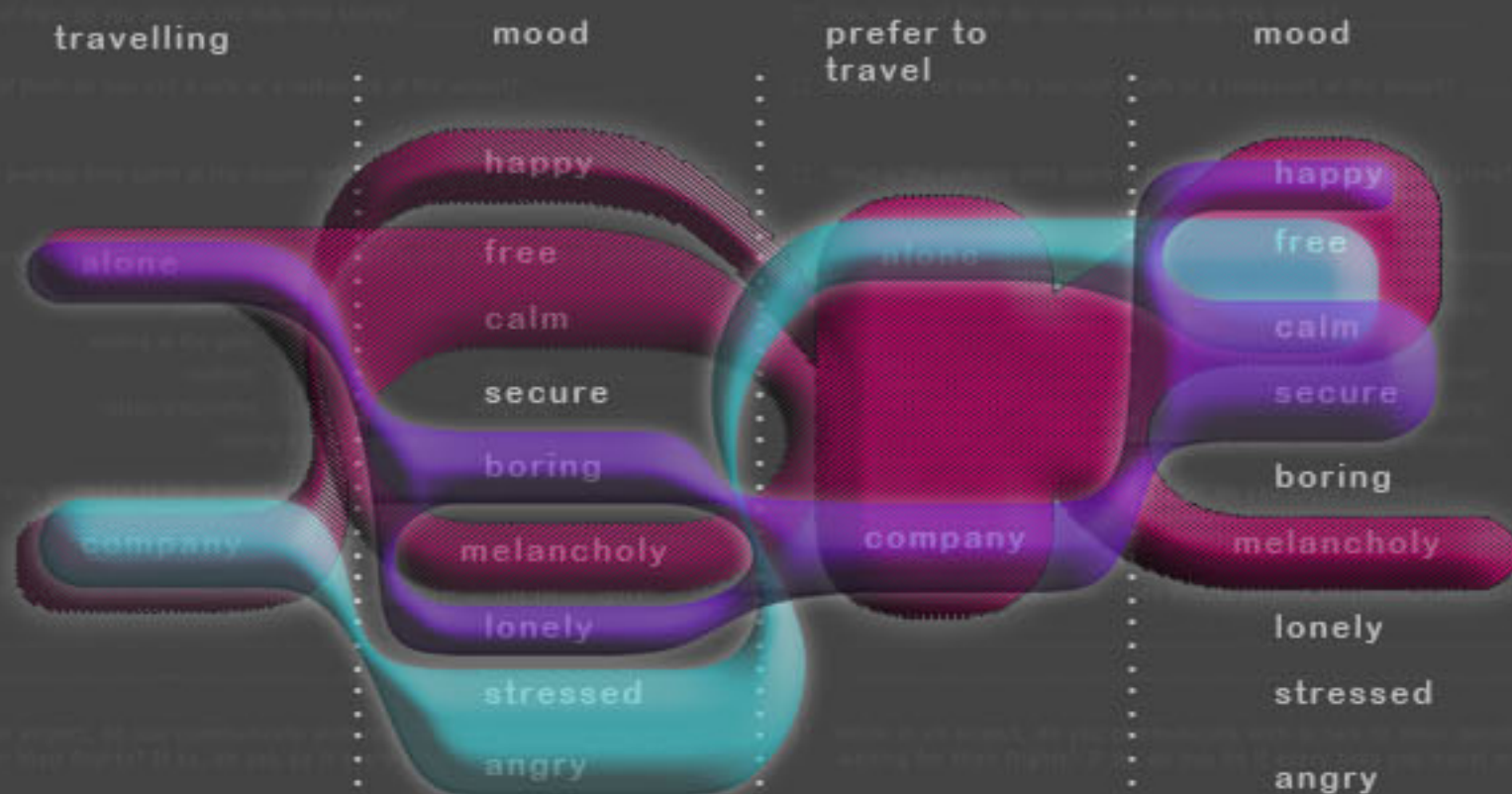

What is your mood while you are waiting alone at the airport and what is your mood while you are waiting with company?
Do you prefer traveling alone or with company and why?

QUESTIONARY*

QUESTIONARY*

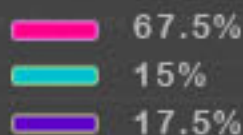
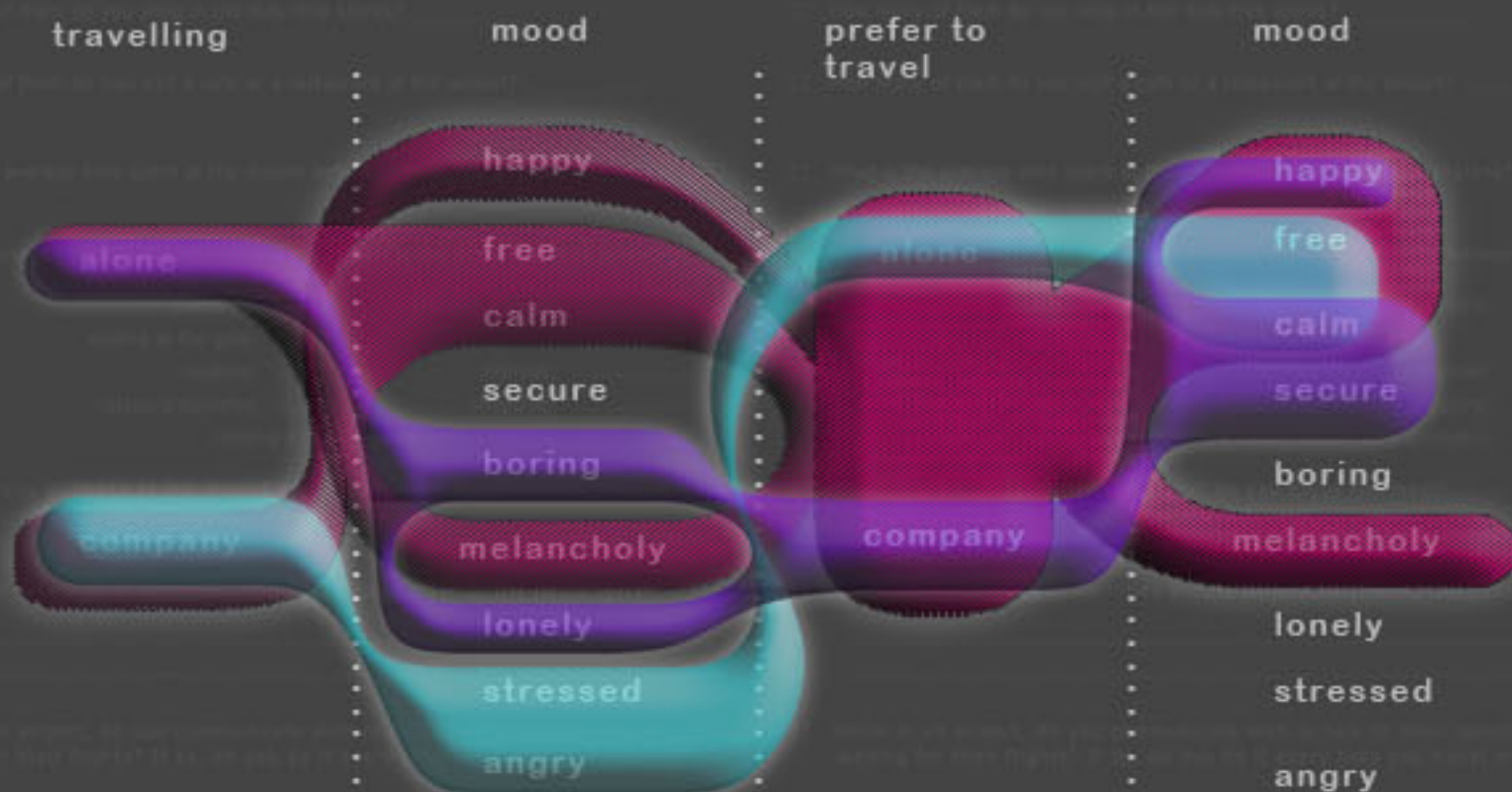

While in an airport, do you communicate with or talk to other people who are also waiting for their flights?
If so, do you do it every time you travel or occasionally?



48.5% sometimes

45% never

8.5% always



DIAGRAM OF INTENT

If we wish to find out what the human is, we should search in what humans are: and what humans are, above all, varies. (...) In other words, if we wish to meet humanity face to face, we have to go into elaborate information, beyond misleading characterisations, metaphysical forms, pointless similarities, in order to realize the substantial character of different cultures and of the kinds of people in each of them, as well. In this study field, the path to the general, to the revelatory simpleness of the science, is succeeded through the consideration of the detailed, the occasional, the particular. (...) - C. Geertz

THE INTENTIONS

- intriguing passengers' sociality skills
- direct contact between the passengers
- exchange of personal history and knowledge

THE MEDIUMS

- spatial stimuli (spatial qualities)
- augmented reality

I am Andrew and I come from Papua New Guinea. In my country, wood carving is a traditional craft, often in the form of plants or animals, representing ancestor spirits. Regarding the languages spoken, they number over 850.

LOCATION OF KASTELLI

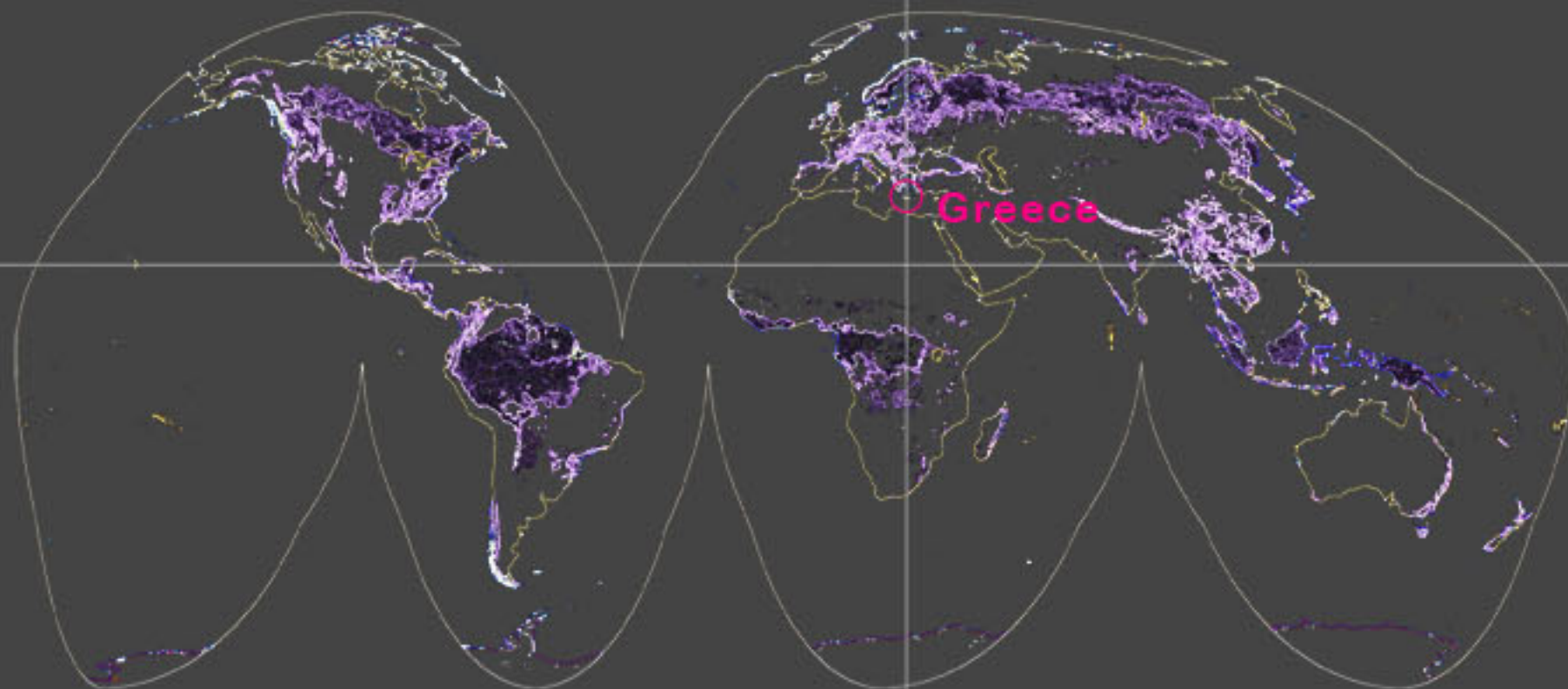

global map

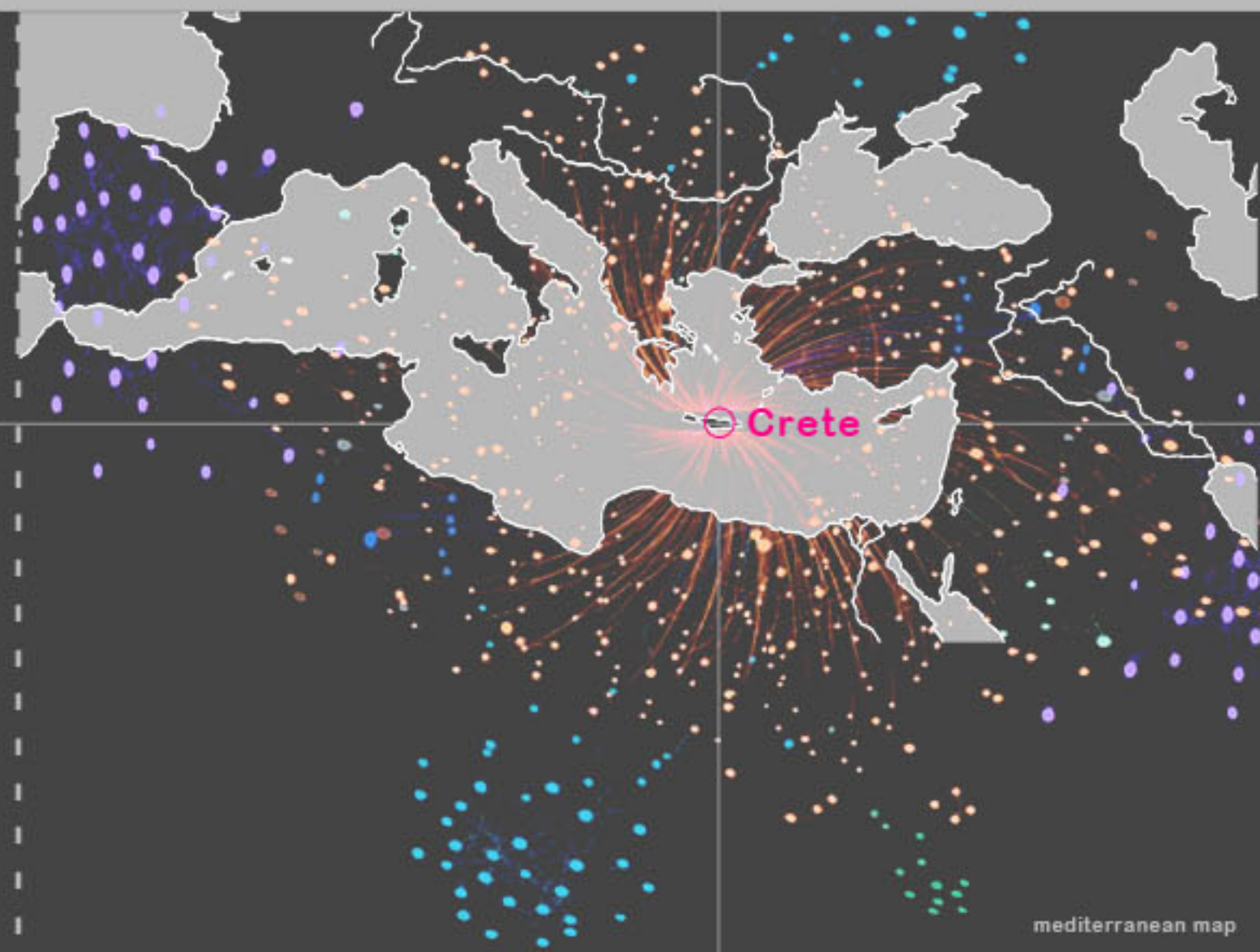

mediterranean map

Greece: borderline between the western and eastern civilization, special geographic location, climate and natural beauty.

Crete: in the center of the Mediterranean sea, connects the 3 continents of Europe, Africa and Asia.

The new international airport in **Kastelli**, Crete, Greece is going to be a transit airport between the western and the eastern side of the Atlantic Ocean and the crossroad of the Mediterranean sea.

Kastelli: near to big touristic areas of Crete.

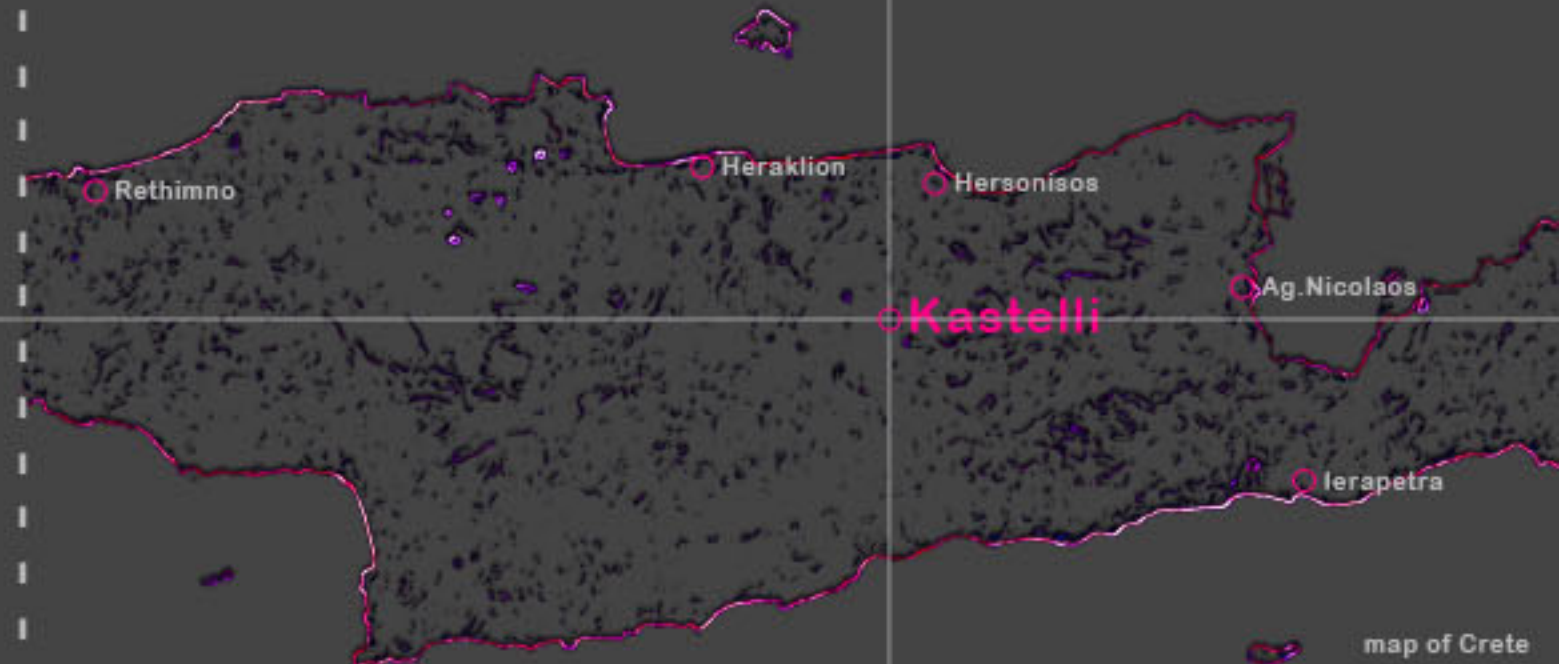

map of Crete

About the form of the airport, **3 curved surfaces** will be folded to create the new building. The 1st curve is coming from the North, the 2nd from the East and the 3rd from the South, **signifying the key location of Crete**, the crossroad of Europe, Asia and Africa. Each one of them will have a different kind of use. The 1st one will include the entrance and the **processing activities** (check-in, security, departure lounges). The 2nd will include the **non-public spaces**: administration offices, maintenance room etc. The 3rd one will include the **discretionary activities** of the passengers (shops, money exchange).

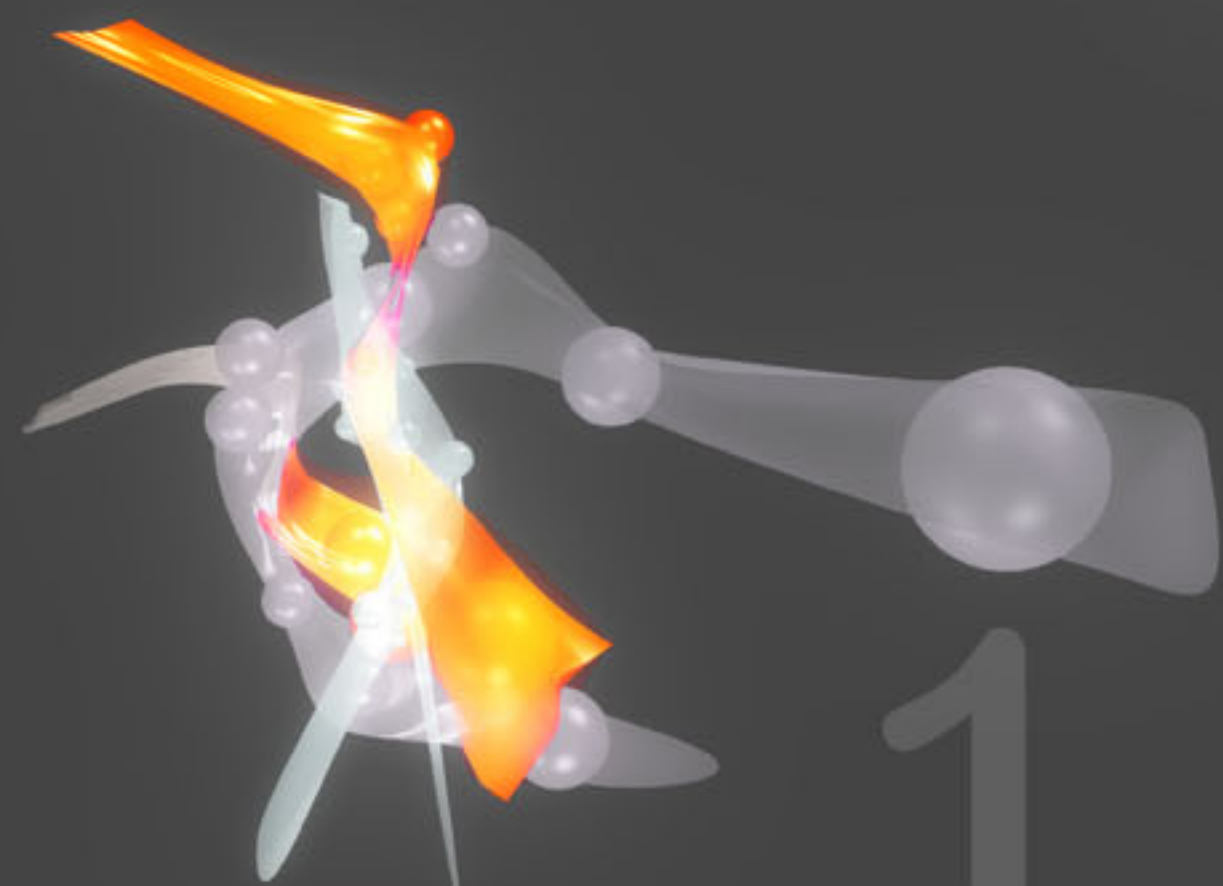
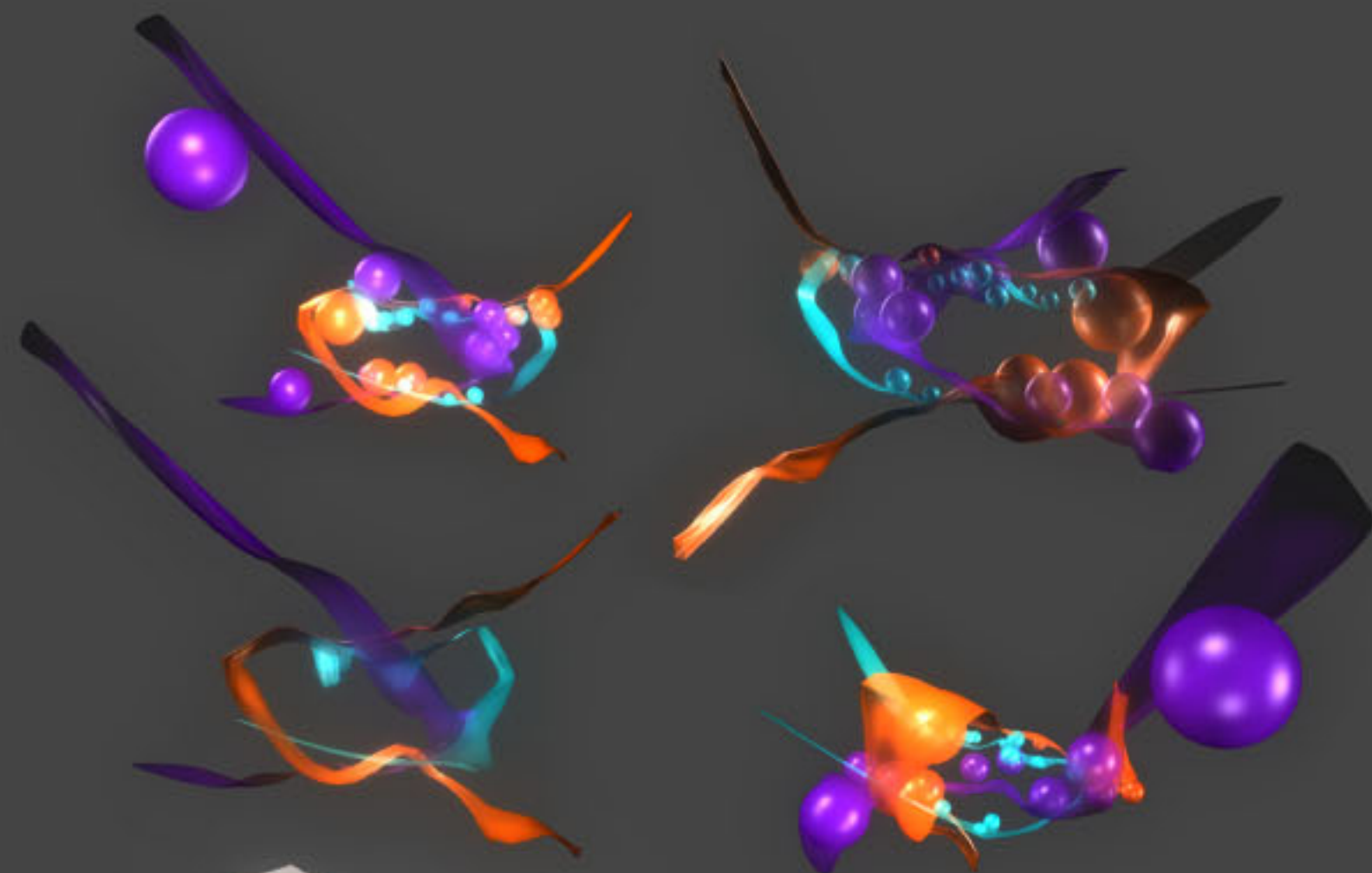
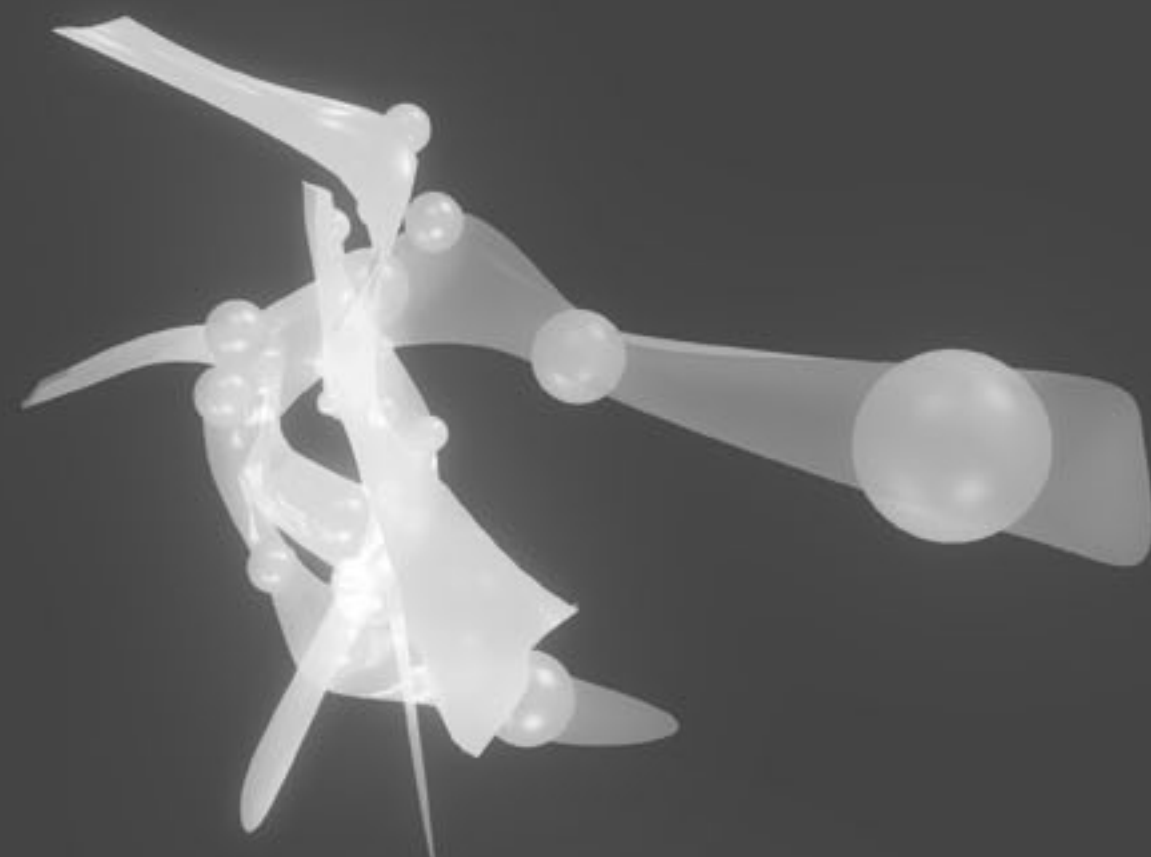

1

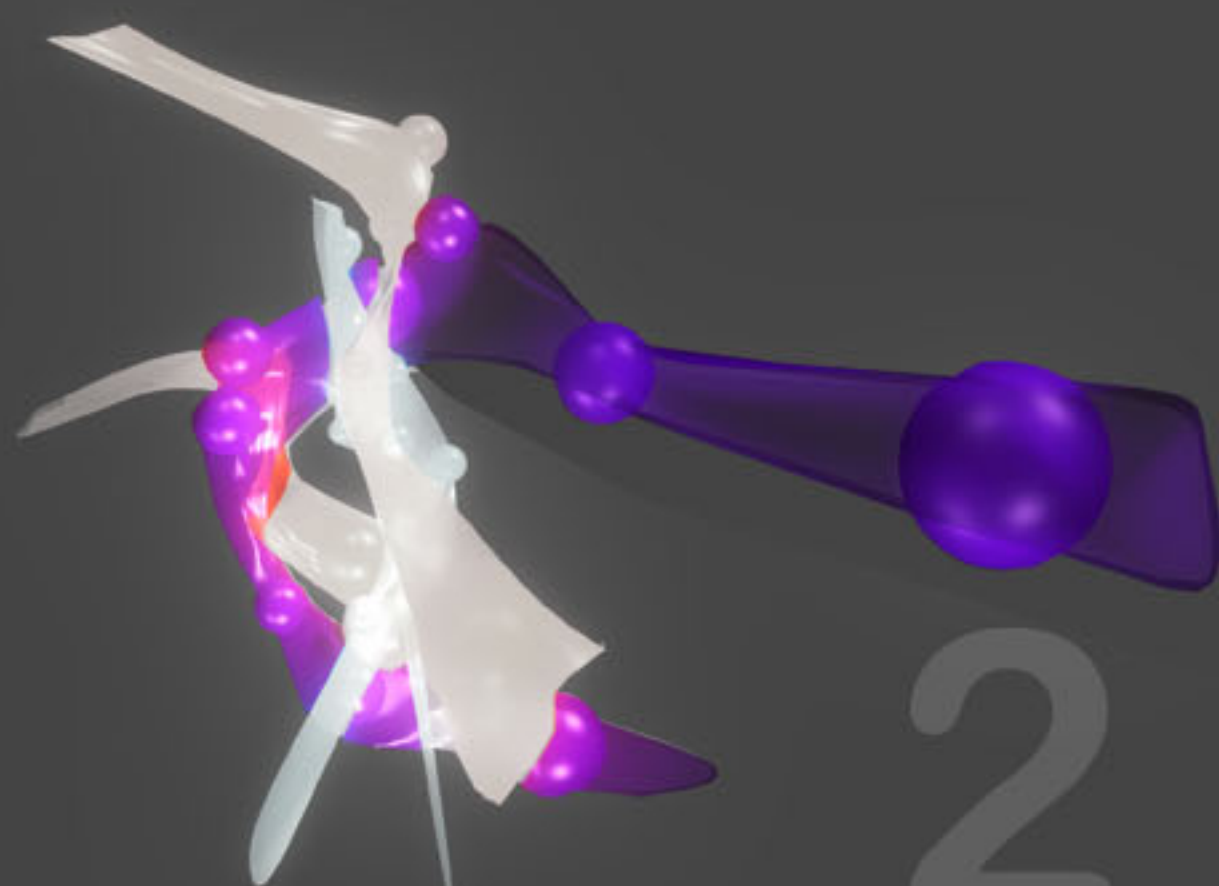

2

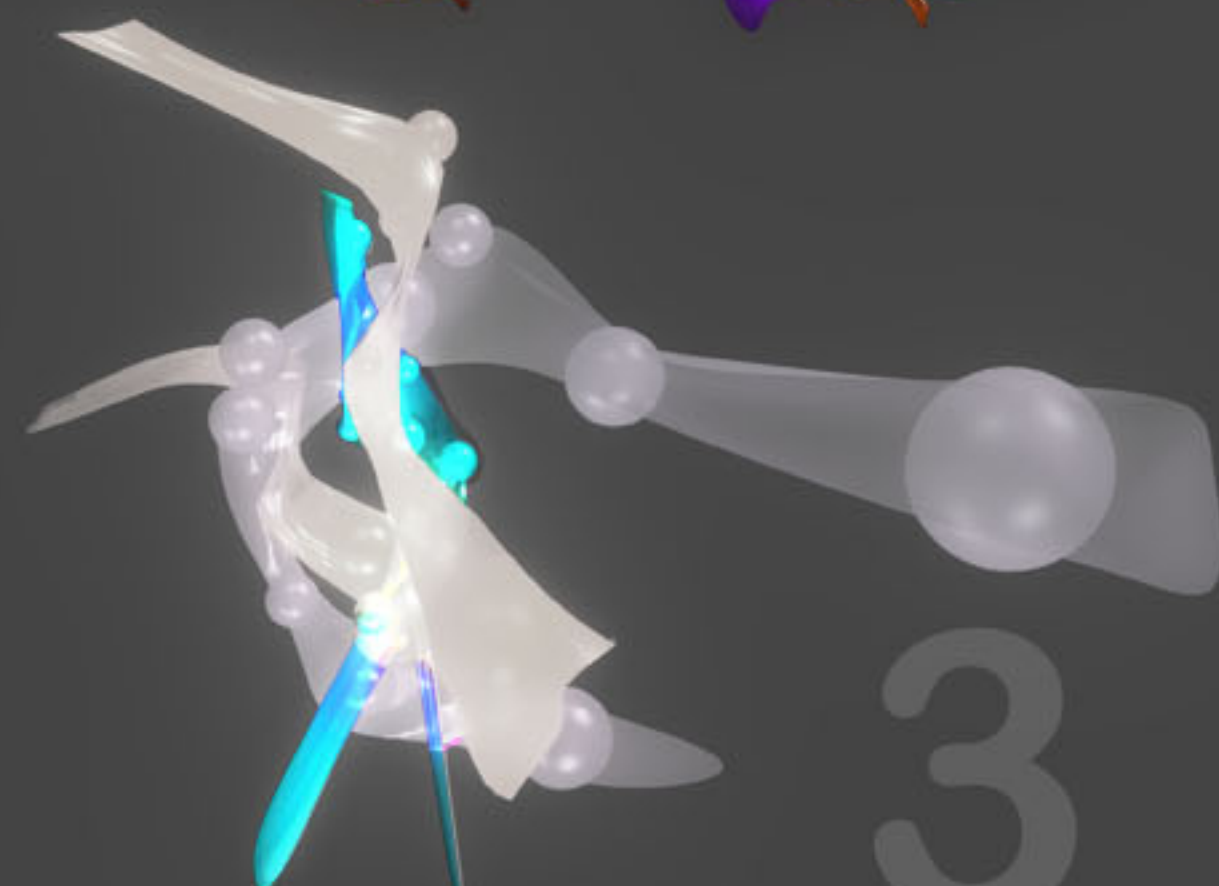

3

FUNCTIONS' PROGRAM

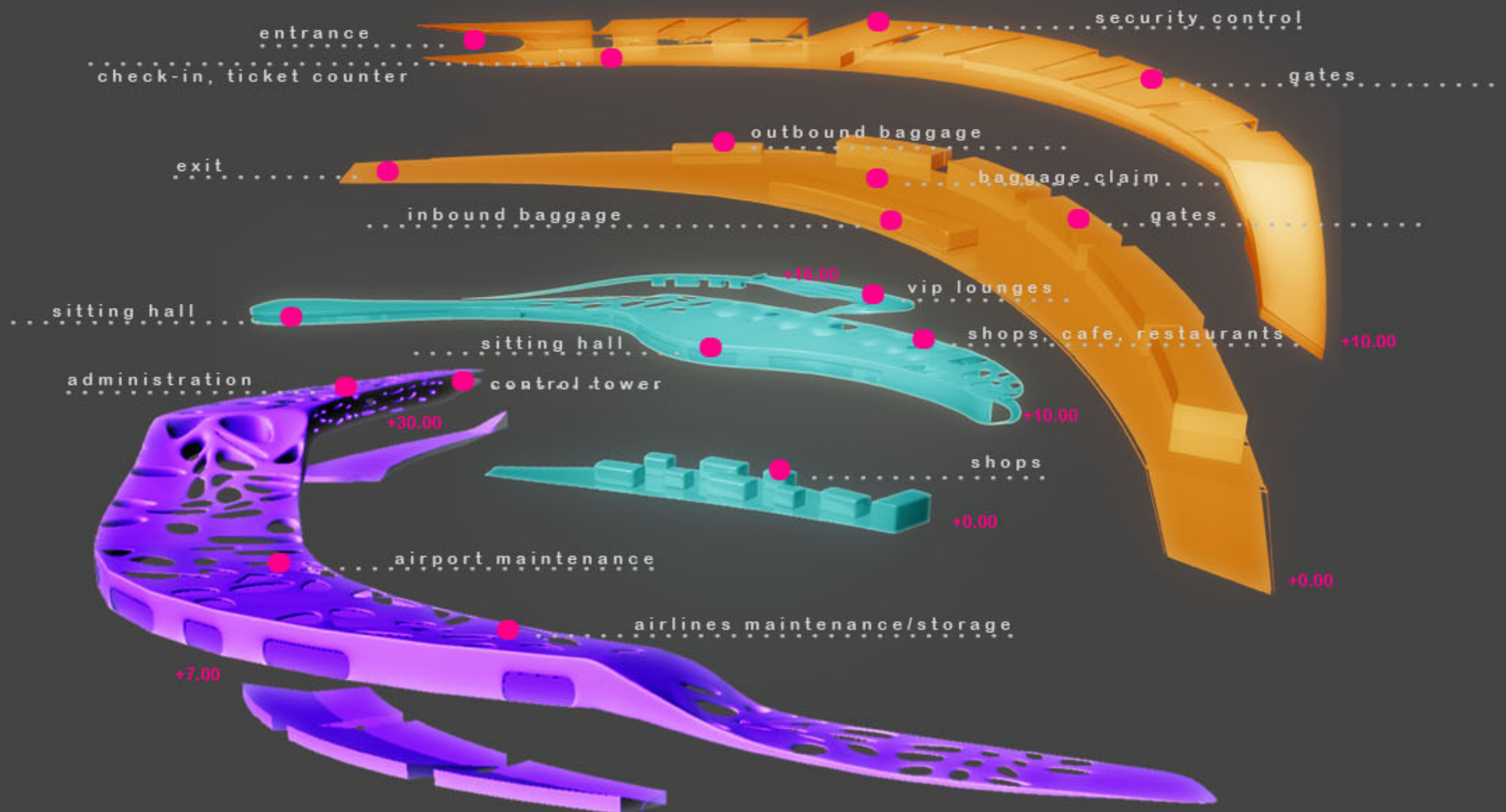

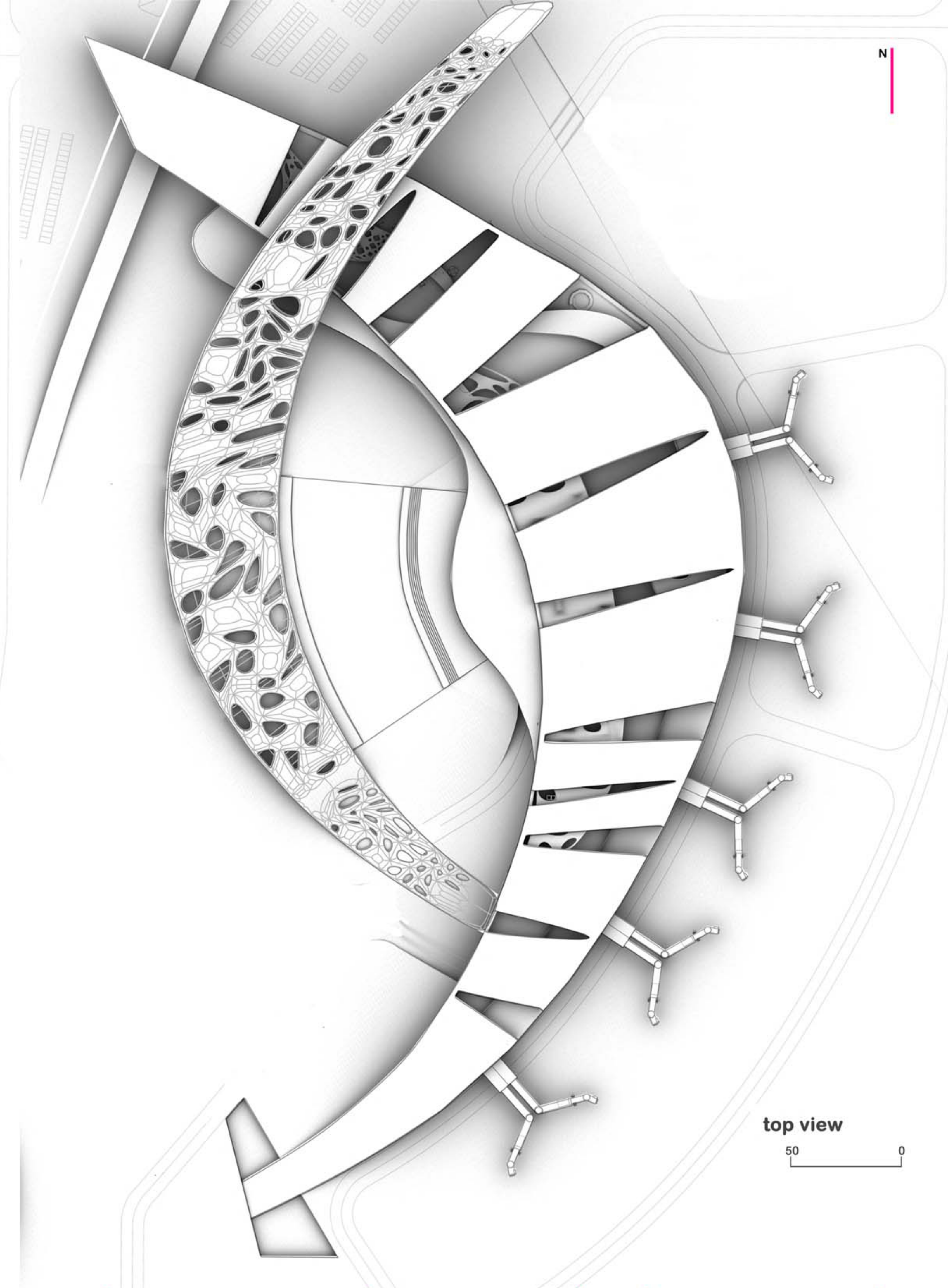
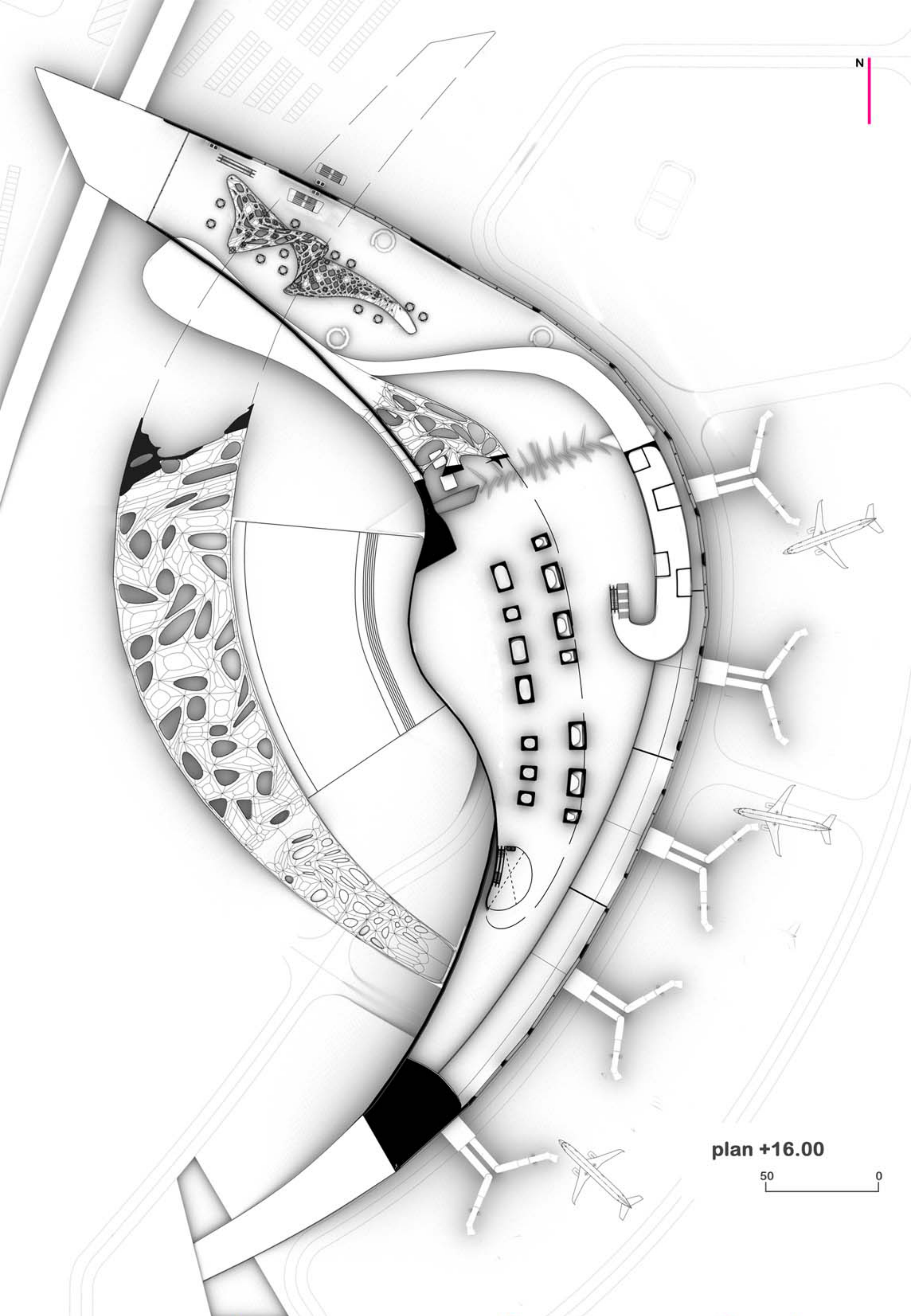

inner
equipment

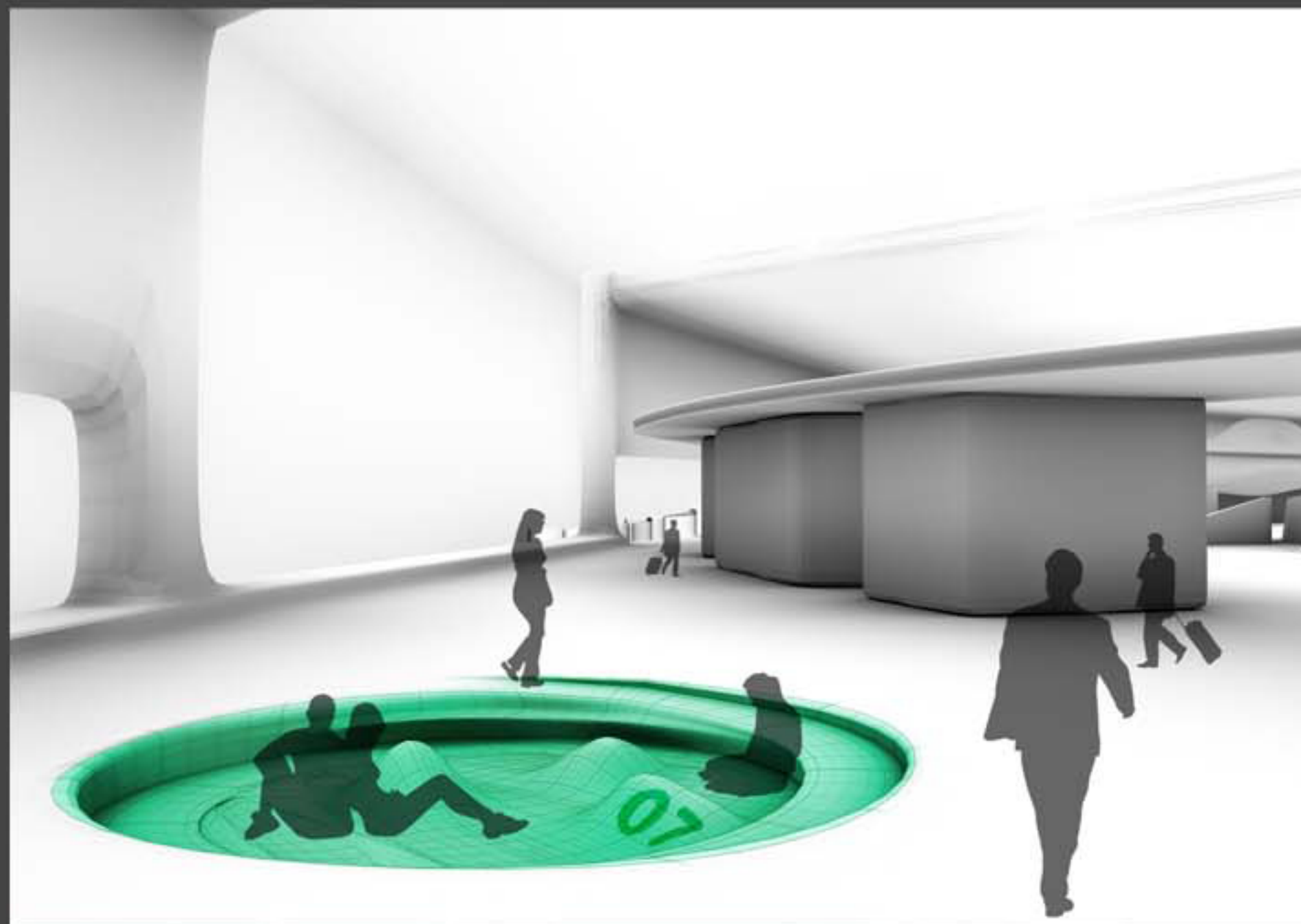
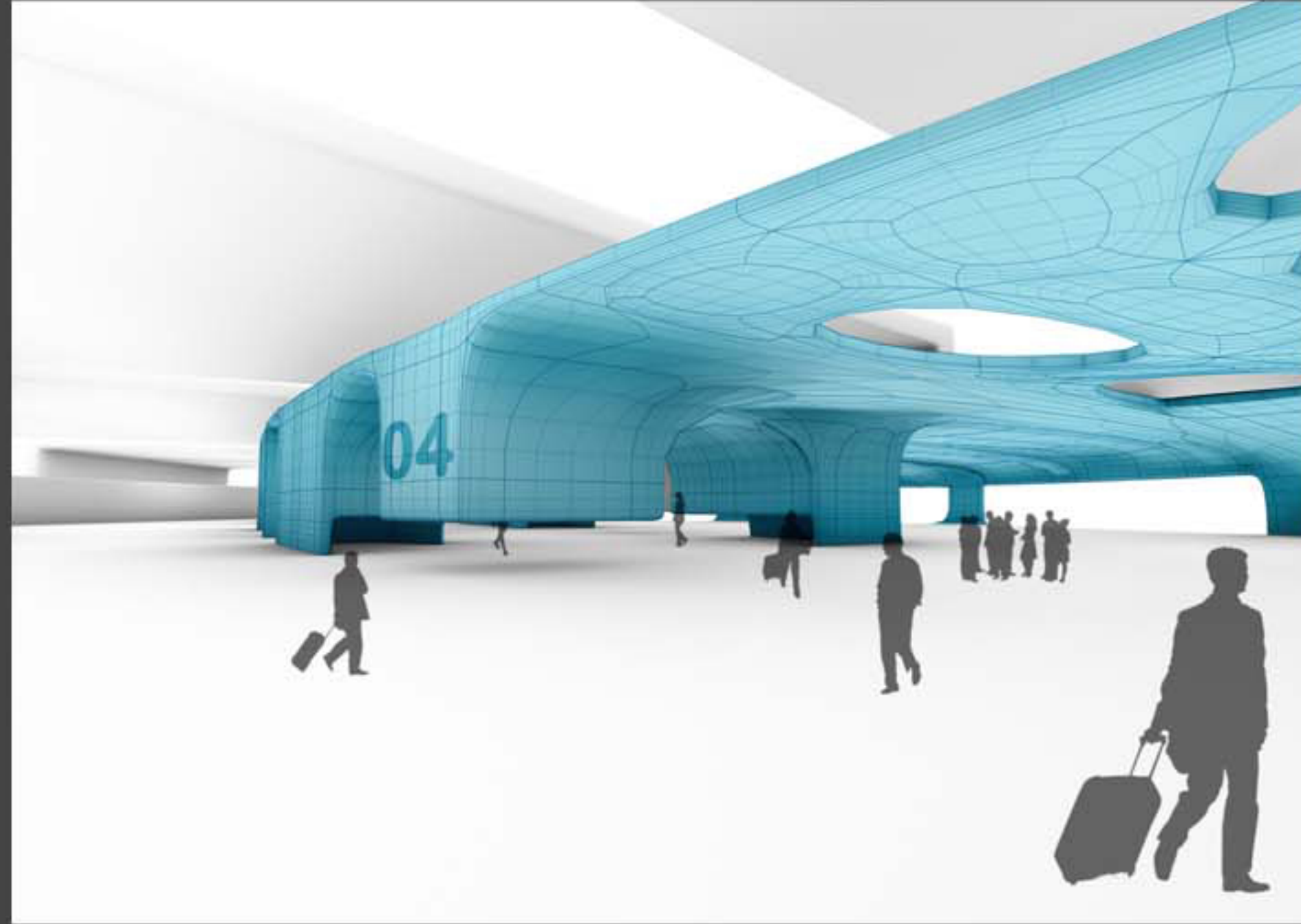
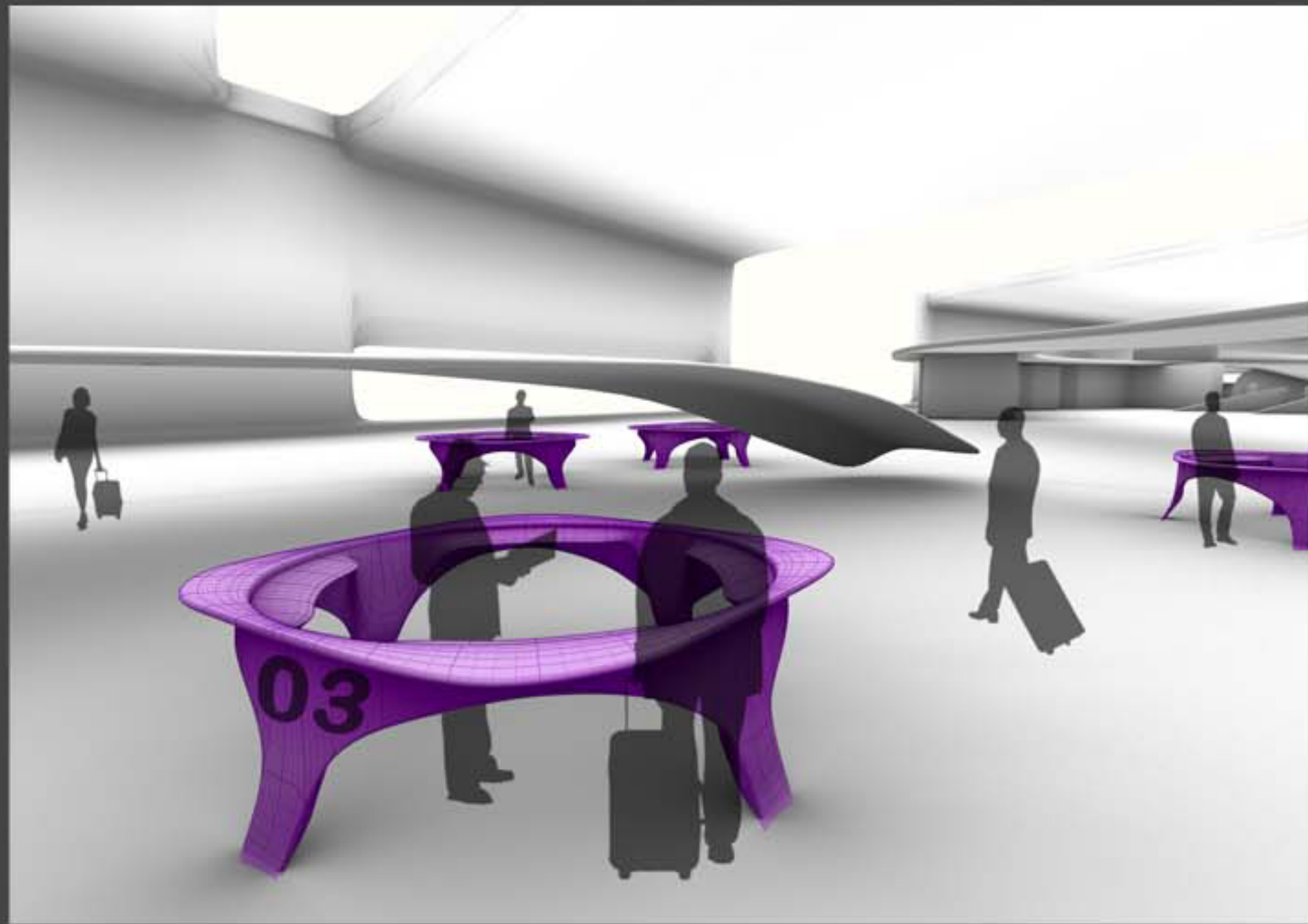
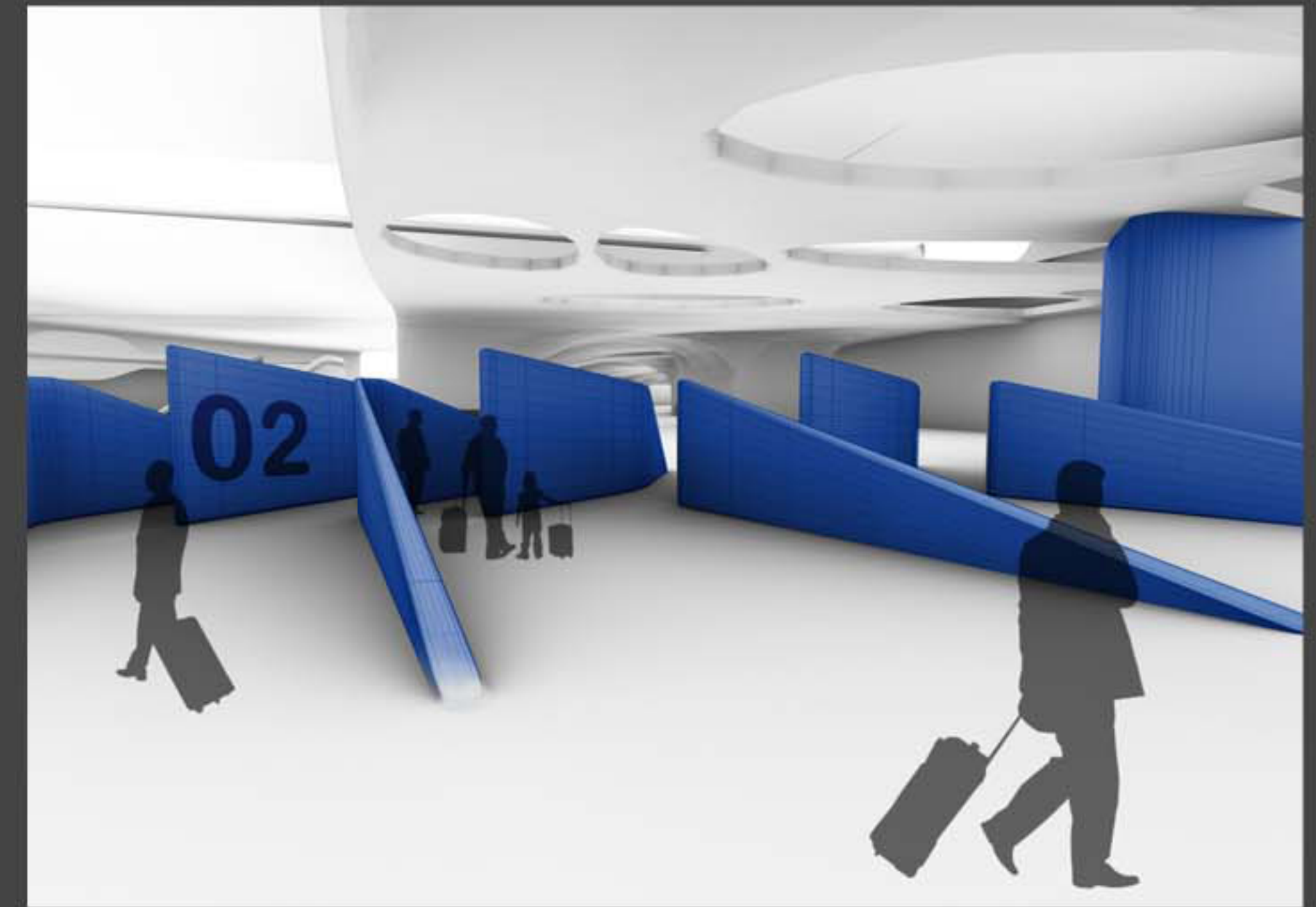

1. check-in
2. security control
3. ticket counter
4. shops, cafe, restaurants
5. seats
6. tables
7. meeting points

far-off view

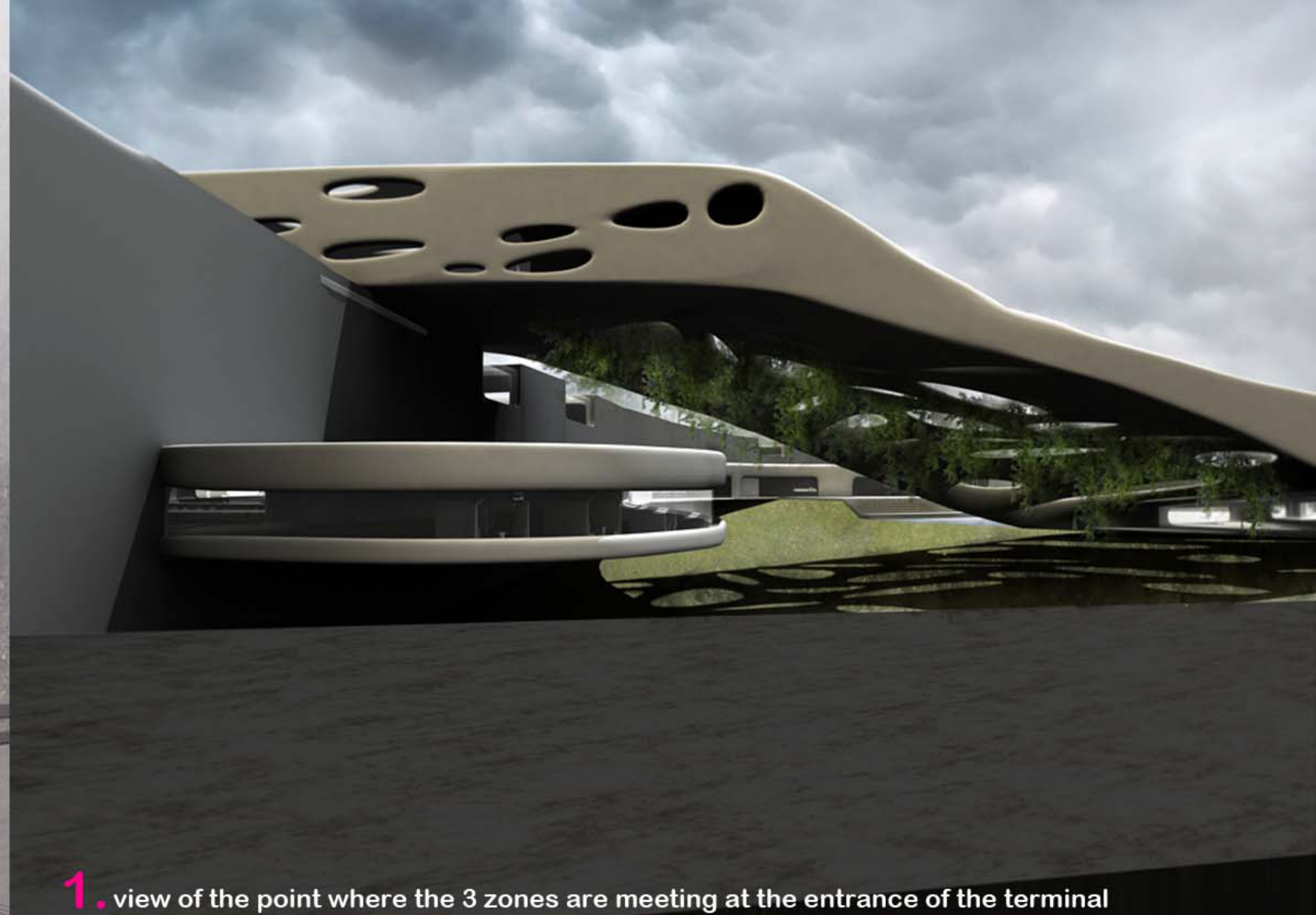
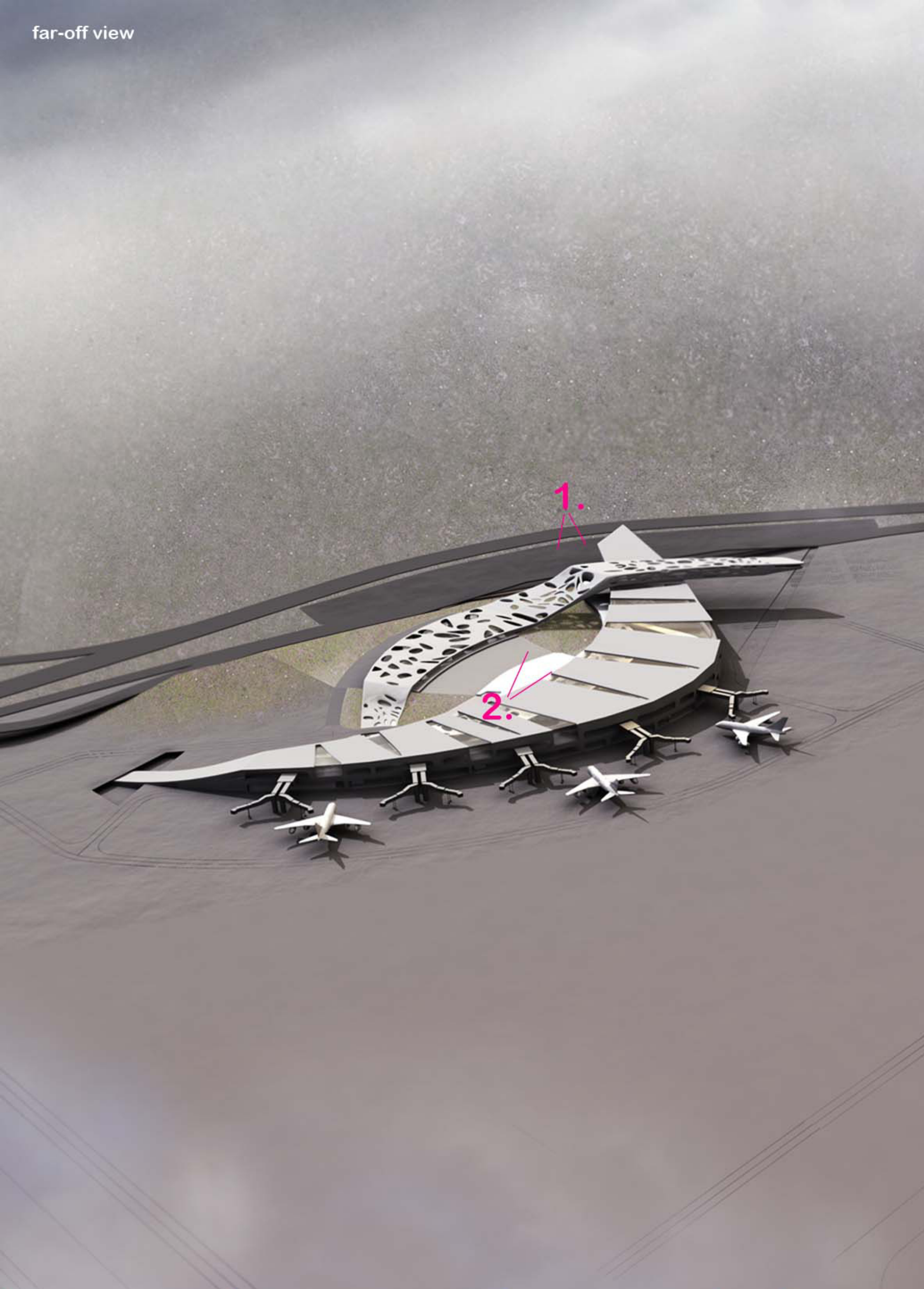

1. view of the point where the 3 zones are meeting at the entrance of the terminal



2. view of the atrium

far-off view

